

THE
Stable Door

44mm COMPOSITE STABLE DOOR

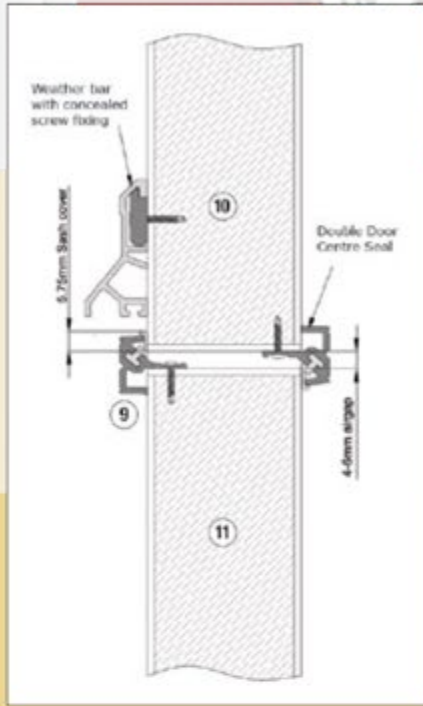

The 44mm COMPOSITE STABLE DOOR



Choice of Decorative Glass



BULLION



ZIRCONIA



LEONITE



PALU



PERLITE



ZIRCONIA



SB ELLIE



LEONITE



PALU



PERLITE



SB OLIVIA



LEONITE



PALU



PERLITE



WHITE



RED



BLUE



GREEN



BLACK



ROSE WOOD



GOLD OAK

STABLE DOOR SPECIFICATION

- Lock Type:** Winkhaus 45mm Backset
- Edge Finish:** Edgebanded (3 Sides)
- Handle Type:** Mila Spartan (White, Gold or Chrome)
- Hinge Type:** Laird Challenger (Qty 4) White Only

STABLE KITS

- Pair escutcheons, one thumb turn for rack bolt.
- Available in White, Gold and Chrome.

NOTE: Stain/White & Stain/Stain Doors Gold Kit Only



STYLES



MORGAN SOLID AUSTIN 1



CATERHAM 1 RILEY 1

Due to printing limitations the colours shown may not be an exact match to the actual door, samples of colour can be provided on request. Hallmark Panels Limited reserve the right to withdraw or replace any of the products shown without prior notice.



Hallmark Panels Limited

Valletta House | Valletta Street | Hedon Road | Hull HU9 5NP

Telephone +44 (0)1482 703222 | Fax +44 (0)1482 701185

www.hallmarkpanels.com



HALLMARK STABLE DOOR ORDER FORM

Tel: 01482 703 222 Fax: 01482 701 185 Email: orders@hallmarkpanels.com

CONTACT INFORMATION

COMPANY: ADDRESS:	DELIVERY ADDRESS (IF DIFFERENT)
TEL: FAX: E-MAIL:	ORDER NUMBER: REQ'D DATE: CUSTOMER REF:

OUTERFRAME: SYSTEM 10

RUSTIQUE

PRODUCT DETAILS

COLOUR OUTSIDE:	White <input type="checkbox"/>	Blue <input type="checkbox"/>	Green <input type="checkbox"/>	Red <input type="checkbox"/>	Black <input type="checkbox"/>	G/Oak <input type="checkbox"/>	Rose/wd <input type="checkbox"/>	G/Oak <input type="checkbox"/>	Rose/wd <input type="checkbox"/>
COLOUR INSIDE:	White	White	White	White	White	White	White	G/Oak <input type="checkbox"/>	Rose/wd <input type="checkbox"/>

STYLE

MORGAN



AUSTIN



CATERHAM



RILEY



Tick Appropriate Box

LOW THRESHOLD	YES <input type="checkbox"/>	NO <input type="checkbox"/>	
56MM PVC <input type="checkbox"/>	44MM ALI <input type="checkbox"/>	15MM MOB <input type="checkbox"/>	
COLOUR	SILVER <input type="checkbox"/>	GOLD <input type="checkbox"/>	
EXT CILL	YES <input type="checkbox"/>	NO <input type="checkbox"/>	
	85MM <input type="checkbox"/>	150MM <input type="checkbox"/>	
BUILD UP	15MM <input type="checkbox"/>	30MM <input type="checkbox"/>	50MM <input type="checkbox"/>

Glass Design	Backing Glass	Spacer Bar Colour
--------------	---------------	-------------------

<p>FURNITURE KITS: (Pair Handles, Pair escutcheons, one thumb turn for rack bolt) White <input type="checkbox"/> Gold <input type="checkbox"/> Chrome <input type="checkbox"/></p> <p>Note: Stain/White & Stain/Stain Doors Gold Kit only</p> <p>HINGE: MAKE: Laird MODEL: White only available</p> <p>DOOR HANDING: LEFT <input type="checkbox"/> RIGHT <input type="checkbox"/></p> <p>LETTER PLATE: YES <input type="checkbox"/> NO <input type="checkbox"/></p>	<p>Viewed from outside</p> <p>HEIGHT</p> <p>WIDTH</p>	<p>Outer Frame Colour</p> <p>White / White <input type="checkbox"/></p> <p>Oak/Oak <input type="checkbox"/></p> <p>Rose/Rose <input type="checkbox"/></p> <p>Oak / White <input type="checkbox"/></p> <p>Rosewood / White <input type="checkbox"/></p>
<p>OVERALL DIMENSIONS</p> <p>WIDTH _____ MM Inc any build up</p> <p>HEIGHT _____ MM inc any cill & or add ons</p>	<p>OPEN IN / OUT</p> <p>HINGED LEFT / RIGHT</p>	

NOTE: For handing, all doors are viewed from the outside.

Please check all details carefully as the door will be manufactured per the above specification